



## FEATURES

**Three sizes**  
50", 67" and 70" cubes

**Superior resolution**  
SXGA+ to 1080p

**Outstanding video performance**  
SmoothPicture™ DLP®

**Intelligent operation**  
SiFi™ color and brightness control

**Easy setup and service**  
Motorized image alignment,  
full front and rear access

**Open architecture electronics**  
Compatible with a wide range of  
3rd party image processors

## The next generation of visual performance in control rooms

The Clarity SP™ Series is the next generation of rear-projection DLP® displays designed for video-rich control rooms and corporate environments. These displays combine high resolution with SmoothPicture™ DLP technology for outstanding video performance.

With the SP Series, Planar set a new standard in reliable, high resolution control room solutions. These displays feature all the hallmarks of Planar's superior design and engineering including excellent image quality, easy set-up, minimized footprint, front and rear serviceability, superior seamless screen technology and easy maintenance, all rolled into a new and innovative design.

The SP Series is available in three sizes, two 4:3 displays with SXGA+ resolution plus a wide 70" display featuring 1080p high definition performance. The flexible design of the SP Series will fit the need of any control room, creating a highly functional, high quality digital display wall with a reasonable cost of ownership.

### Intelligent design

All SP Series displays are intelligent digital displays, capable of monitoring and automatically adjusting both color and brightness balance through our revolutionary new Set it and Forget it (SiFi™) technology. SiFi is a proprietary system that enables brightness control and auto lamp switching through an easy-to-use remote interface. It helps users quickly and easily balance brightness, contrast and color across a wall of cubes.

The SP Series also incorporates user friendly set up and maintenance tools such as our patented six axis motor remote control image alignment, full front and rear serviceability and modular design for easy service.

# CLARITY c50SP

## front

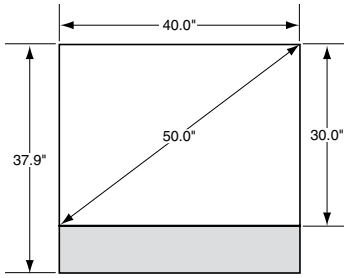

## side

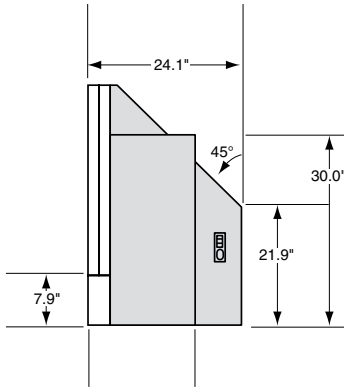

<b>Display resolution</b>	SXGA+ (1400 x 1050)		
<b>Display technology</b>	SmoothPicture™ DLP*		
<b>Aspect ratio (W:H)</b>	4:3		
<b>Screen dimensions</b>			
Diagonal	50" (127 cm)		
Width by Height	40" x 30" (101.6 cm x 76.2 cm)		
<b>Cabinet dimensions (WxHxD)</b>	40" x 37.9" x 24.1" (101.6 cm x 96.3 cm x 61.4 cm)		
<b>Maximum stack height</b>	6 high (requires supplemental support)		
<b>Screen type</b>	<b>Wide-view (WV)</b>	<b>High-bright (HB)</b>	
Full viewing angle	180°	180°	
Viewing angle (1/5 gain)	+/-70° V/H	+/-18° V; +/-48° H	
Viewing angle (1/2 gain)	+/-38° V/H	+/-10° V; +/-33° H	
<b>Border (typical)</b>	0		
<b>Screen to screen gap</b>	< 0.7 mm		
<b>Brightness-Optimal</b>			
100 watt	181 cd/m <sup>2</sup> (53 ftL)	645 cd/m <sup>2</sup> (188 ftL)	
132 watt	360 cd/m <sup>2</sup> (105 ftL)	876 cd/m <sup>2</sup> (256 ftL)	
<b>ANSI lumens</b>	560		
<b>Contrast ratio (full field)</b>	< 2500:1		
<b>Image alignment</b>	6-Axis servo motor control		
<b>Brightness uniformity</b>	> 90%		
<b>Color and brightness control (optional)</b>	Automatic via SiFi (Set It and Forget It™) Auto Color Balance		
<b>Weight*</b>	125 lbs (67 kg)		
<b>Lamp type</b>	100 watt UHP Long Life Dual auto switching 132 watt UHP High Bright Single		
<b>Lamp life** (median)</b>	<b>Long life dual</b>	<b>Long life single</b>	<b>High bright single</b>
	20,000 hours (10,000 x 2)	10,000 hours	10,000 hours
<b>Power consumption</b>	< 250 watts		
<b>Serviceability</b>	Full front/Full rear access		
<b>Rear clearance</b>	Zero required		
<b>Colors</b>	16.7 million		
<b>Color gamut</b>	> 70% NTSC, 100% EBU		
<b>Operating temperature</b>	5-30°C (20° +/-3C for optimal screen performance)		
<b>Non-operating temperature</b>	-10°C to 50°C		
<b>Operating humidity</b>	20-80% RH non-condensing		
<b>Safety regulations</b>	FCC Class A, EN55022/CISPR22, ICES-003, CNS 13438, EN55024, EN60950, TUV Rheinland		
<b>Ambient noise</b>	40 dB (typical)		
<b>WallNet™</b>	Supported		
<b>Big Picture</b>	Supported		
<b>Data input (standard)</b>	VGA to FHD (1920x1080 @60Hz)		
Analog	DSUB 15 pin connector x2 with loop through		
Digital	DVI-D with loop through		
<b>Video input (optional)</b>	SDI (NTSC/PAL, 720, 1080i) BNCx2 with loop through Composite (NTSC/PAL/SECAM) with loop through S-Video (NTSC/PAL) with loop through Component-HD (NTSC/PAL, 480p-1080p) RCAx3 with loop through		
<b>Display control</b>	IR remote, RS-232, RS-485 with loop through, WallNet		

\*Weight and dimensions are approximate. Specifications and design are subject to change without notice. This product may be subject to export control regulations.  
\*\*Lamp manufacturer specs at IEC 61947-1 test conditions.

# CLARITY c67SP

## front

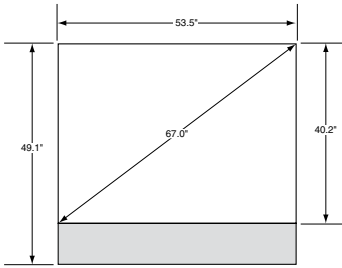

## side

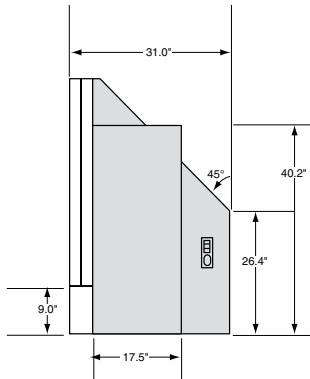

<b>Display resolution</b>	SXGA+ (1400 x 1050)		
<b>Display technology</b>	SmoothPicture™ DLP*		
<b>Aspect ratio (W:H)</b>	4:3		
<b>Screen dimensions</b>			
Diagonal	67" (170.0 cm)		
Width by Height	53.5" x 40.2" (136 cm x 102 cm)		
<b>Cabinet dimensions (WxHxD)</b>	53.5" x 49.1" x 31" (136 cm x 124.9 cm x 78.8 cm)		
<b>Maximum stack height</b>	6 high (requires supplemental support)		
<b>Screen type</b>			
	<b>Wide-view (WV)</b>	<b>High-bright (HB)</b>	
Full viewing angle	180°	180°	
Viewing angle (1/5 gain)	+/-70° V/H	+/-18° V; +/-48° H	
Viewing angle (1/2 gain)	+/-38° V/H	+/-10° V; +/-33° H	
<b>Border (typical)</b>	0		
<b>Screen to screen gap</b>	< 0.7 mm		
<b>Brightness-Optimal</b>			
100 watt	101 cd/m <sup>2</sup> (30 fTL)	358 cd/m <sup>2</sup> (105 fTL)	
132 watt	200 cd/m <sup>2</sup> (59 fTL)	488 cd/m <sup>2</sup> (143 fTL)	
<b>ANSI lumens</b>	560		
<b>Contrast ratio (full field)</b>	< 2500:1		
<b>Image alignment</b>	6-Axis servo motor control		
<b>Brightness uniformity</b>	> 90%		
<b>Color and brightness control (optional)</b>	Automatic via SiFi (Set It and Forget It™) Auto Color Balance		
<b>Weight*</b>	190 lbs (86 kg)		
<b>Lamp type</b>			
	100 watt UHP Long Life Dual auto switching		
	132 watt UHP High Bright Single		
<b>Lamp life** (median)</b>			
	<b>Long life dual</b>	<b>Long life single</b>	<b>High bright single</b>
	20,000 hours (10,000 x 2)	10,000 hours	10,000 hours
<b>Power consumption</b>	< 250 watts		
<b>Serviceability</b>	Full front/Full rear access		
<b>Rear clearance</b>	Zero required		
<b>Colors</b>	16.7 million		
<b>Color gamut</b>	> 70% NTSC, 100% EBU		
<b>Operating temperature</b>	5-30°C (20° +/-3C for optimal screen performance)		
<b>Non-operating temperature</b>	-10°C to 50°C		
<b>Operating humidity</b>	20-80% RH non-condensing		
<b>Safety regulations</b>	FCC Class A, EN55022/CISPR22, ICES-003, CNS 13438, EN55024, EN60950, TUV Rheinland		
<b>Ambient noise</b>	40 dB (typical)		
<b>WallNet™</b>	Supported		
<b>Big Picture</b>	Supported		
<b>Data input (standard)</b>			
Analog	VGA to FHD (1920x1080 @60Hz)		
Digital	DSUB 15 pin connector x2 with loop through DVI-D with loop through		
<b>Video input (optional)</b>			
	SDI (NTSC/PAL, 720, 1080i) BNCx2 with loop through		
	Composite (NTSC/PAL/SECAM) with loop through		
	S-Video (NTSC/PAL) with loop through		
	Component-HD (NTSC/PAL, 480p-1080p) RCAx3 with loop through		
<b>Display control</b>	IR remote, RS-232, RS-485 with loop through, WallNet		

\*Weight and dimensions are approximate. Specifications and design are subject to change without notice. This product may be subject to export control regulations.  
\*\*Lamp manufacturer specs at IEC 61947-1 test conditions.

## connection panel

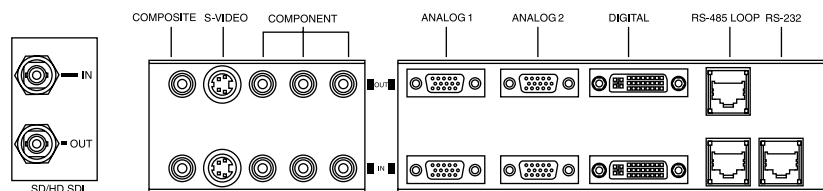

# CLARITY c70SPw

front

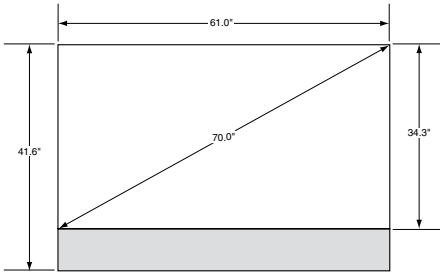

side

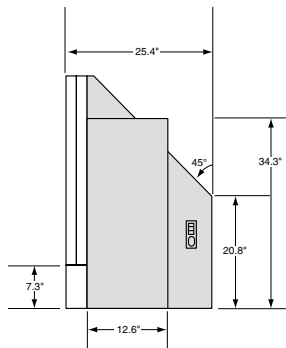

## For more information

To learn more about the Clarity SP series of control room displays by Planar Systems, call 503-748-1100 or visit [www.planarcontrolroom.com](http://www.planarcontrolroom.com).

Display resolution	1080p (1920 x 1080)		
Display technology	SmoothPicture™ DLP*		
Aspect ratio (W:H)	16:9		
Screen dimensions	Diagonal 70" (177.8 cm)		
	Width by Height 61" x 34.3" (154.9 cm x 87.1 cm)		
Cabinet dimensions (WxHxD)	61" x 41.6" x 25.4" (155 cm x 105.6 cm x 64.6 cm)		
Maximum stack height	4 high (requires supplemental support)		
Screen type	Wide-view (WV)	High-bright (HB)	PrecisionView™-2 (PV2)
Full viewing angle	180°	180°	180°
Viewing angle (1/5 gain)	+/-70° V/H	+/-18° V; +/-48° H	+/-48° V; +/-51° H
Viewing angle (1/2 gain)	+/-38° V/H	+/-10° V; +/-33° H	+/-32° V; +/-37° H
Border (typical)	0	0	0
Screen to screen gap	< 0.7 mm	< 0.7 mm	< 0.7 mm
Brightness-Optimal			
100 watt	114 cd/m <sup>2</sup> (34 fL)	441 cd/m <sup>2</sup> (128 fL)	205 cd/m <sup>2</sup> (60 fL)
132 watt	164 cd/m <sup>2</sup> (48 fL)	635 cd/m <sup>2</sup> (185 fL)	295 cd/m <sup>2</sup> (86 fL)
ANSI lumens	560		
Contrast ratio (full field)	< 2500:1		
Image alignment	6-Axis servo motor control		
Brightness uniformity	> 85%		
Color and brightness control (optional)	Automatic via Sifi (Set It and Forget It™) Auto Color Balance		
Weight*	165 lbs (75 kg)		
Lamp type	100 watt UHP Long Life Dual auto switching		
	132 watt UHP High Bright Single		
Lamp life** (median)	Long life dual	Long life single	High bright single
	20,000 hours (10,000 x 2)	10,000 hours	10,000 hours
Power consumption	< 250 watts		
Serviceability	Full front/Full rear access		
Rear clearance	Zero required		
Colors	16.7 million		
Color gamut	> 70% NTSC, 100% EBU		
Operating temperature	5-30°C (20° +/-3C for optimal screen performance)		
Non-operating temperature	-10°C to 50°C		
Operating humidity	20-80% RH non-condensing		
Safety regulations	FCC Class A, EN55022/CISPR22, ICES-003, CNS 13438, EN55024, EN60950, TUV Rheinland		
Ambient noise	40 dB (typical)		
WallNet™	Supported		
Big Picture	Supported		
Data input (standard)	VGA to FHD (1920x1080 @60Hz)		
Analog	DSUB 15 pin connector x2 with loop through		
Digital	DVI-D with loop through		
Video input (optional)	SDI (NTSC/PAL, 720, 1080i) BNCx2 with loop through		
	Composite (NTSC/PAL/SECAM) with loop through		
	S-Video (NTSC/PAL) with loop through		
	Component-HD (NTSC/PAL, 480p-1080p) RCAx3 with loop through		
Display control	IR remote, RS-232, RS-485 with loop through, WallNet		

\*Weight and dimensions are approximate. Specifications and design are subject to change without notice. This product may be subject to export control regulations.  
\*\*Lamp manufacturer specs at IEC 61947-1 test conditions.

**PLANAR**

When image experience matters.

Planar Systems, Inc.  
1195 NW Compton Drive  
Beaverton, OR, 97006-1992, USA  
Toll Free +1-866-475-2627  
[www.planar.com](http://www.planar.com)

Planar is a trademark of Planar Systems, Inc. All other trade and service marks are the property of their holders.

Copyright © 2010 Planar Systems, Inc. All rights reserved. This document may not be copied in any form without written permission from Planar Systems, Inc. Information in this document is subject to change without notice.

15239 05/10